

Washpoint Assembly instructions

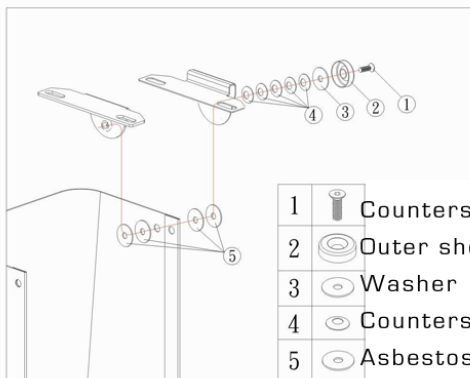

- | | | |
|---|--|-------------------------------|
| 1 | | Countersunk Screw |
| 2 | | Outer shell for basin's screw |
| 3 | | Washer |
| 4 | | Countersunk spring washer |
| 5 | | Asbestos washer |



1 - Remove the back fixing plate of the body support by loosening the 6 screws as illustrated



2. Fit the basin onto the body support



3. Adjust basin as required by moving forward and backward



4. Tighten down the basin bolts with the wrench provided on each carriage screw



5. Refit back cover using the screws provided