

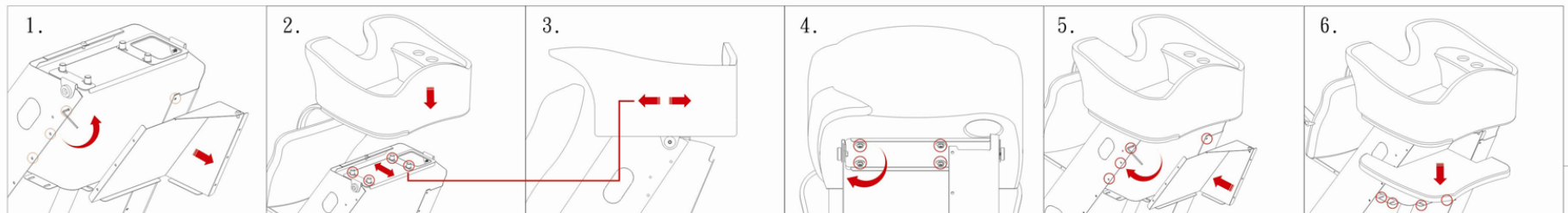

www.wbx europe.com
the very best in salon seating

Washpoint assembly instructions

Parts Kit

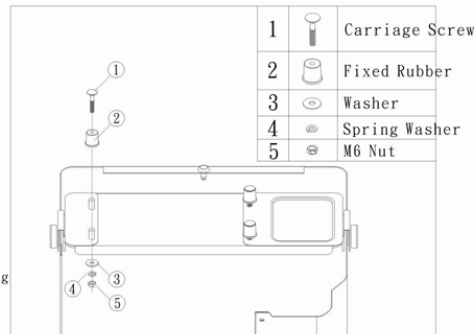
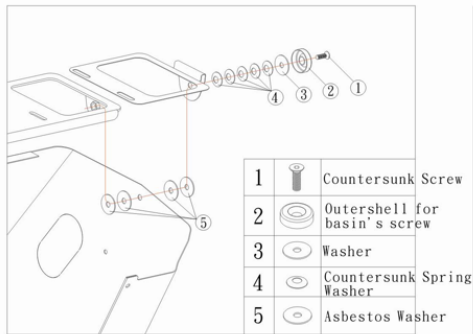

1. Remove the Back Fix Plate of the Body Support. To remove it, loose the 6 screw by wrench given.

2. Fix the basin with the Body Support by aligning the four holes at the bottom of the basin with the carriage screw.

3. Adjust the basin to the most comfortable position by moving forward or backward of each carriage screw.

4. Lock-on the carriage screw to tight the basin with the Body Support.

5. Put the Back Fix Plate back and lock on the 6 screw.

6. Lastly, put in the contain board and lock on the four screw as illustrated.